



Appendix C: Oversize Maps



San Diego Bay Habitats

LEGEND

Bay Habitats	
<div></div>	Deep subtidal (>20 ft)
<div></div>	Moderately deep subtidal (12 - 20 ft)
<div></div>	Shallow Subtidal (-2 to -12 ft)*
<div></div>	Intertidal areas (+2 to -2 ft)*
<div></div>	Marsh
<div></div>	Submerged aquatic vegetation
<div></div>	Artificial shorelines (riprap, seawalls, etc.)
*Actual intertidal range is +7.8 to -2.3 ft. Data layers for those contours unavailable.	
Other Types	
<div></div>	Upland transition
<div></div>	Riparian (Otay)
<div></div>	Old agricultural fields
<div></div>	Fill - sparsely vegetated
Saltworks	
<div></div>	crystallizer
<div></div>	pickling
<div></div>	primary
<div></div>	primary/intertidal
<div></div>	secondary
<div></div>	Sweetwater/Otay Drainage Boundary
<div></div>	Watersheds
<div></div>	Streams
<div></div>	1859 High Tide Line

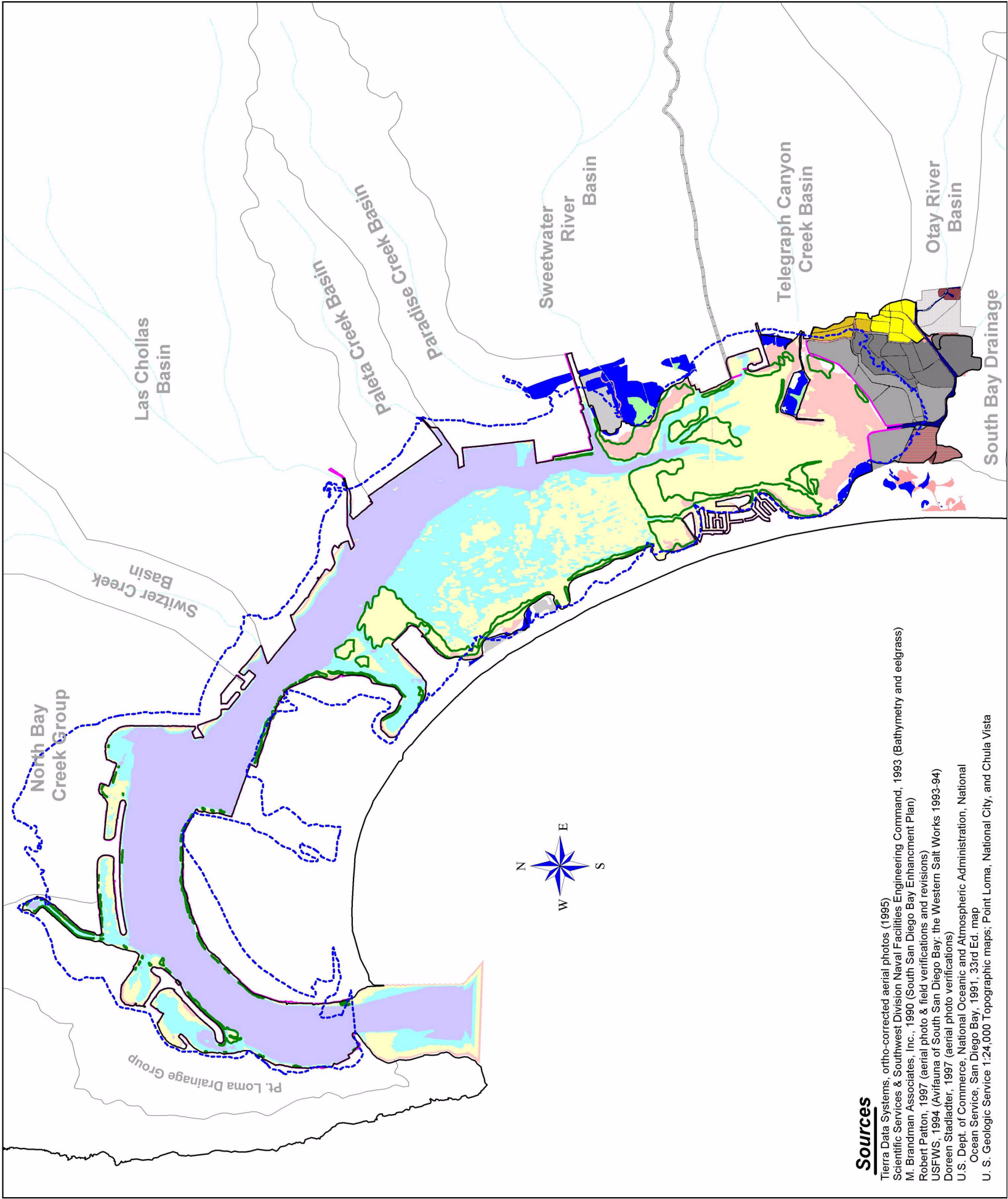
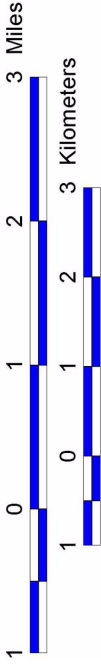

Sources

Tierra Data Systems, ortho-corrected aerial photos (1995)
Scientific Services & Southwest Division Naval Facilities Engineering Command, 1993 (Bathymetry and eelgrass)
M. Brandman Associates, Inc., 1990 (South San Diego Bay Enhancement Plan)
Robert Patton, 1997 (aerial photo & field verifications and revisions)
USFWS, 1994 (Avifauna of South San Diego Bay: the Western Salt Works 1993-94)
Doreen Stadlader, 1997 (aerial photo verifications)
U.S. Dept. of Commerce, National Oceanic and Atmospheric Administration, National Ocean Service, San Diego Bay, 1991, 33rd Ed. map
U. S. Geologic Service 1:24,000 Topographic maps; Point Loma, National City, and Chula Vista

Map C-1. Habitats of San Diego Bay.



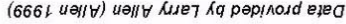







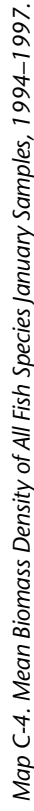



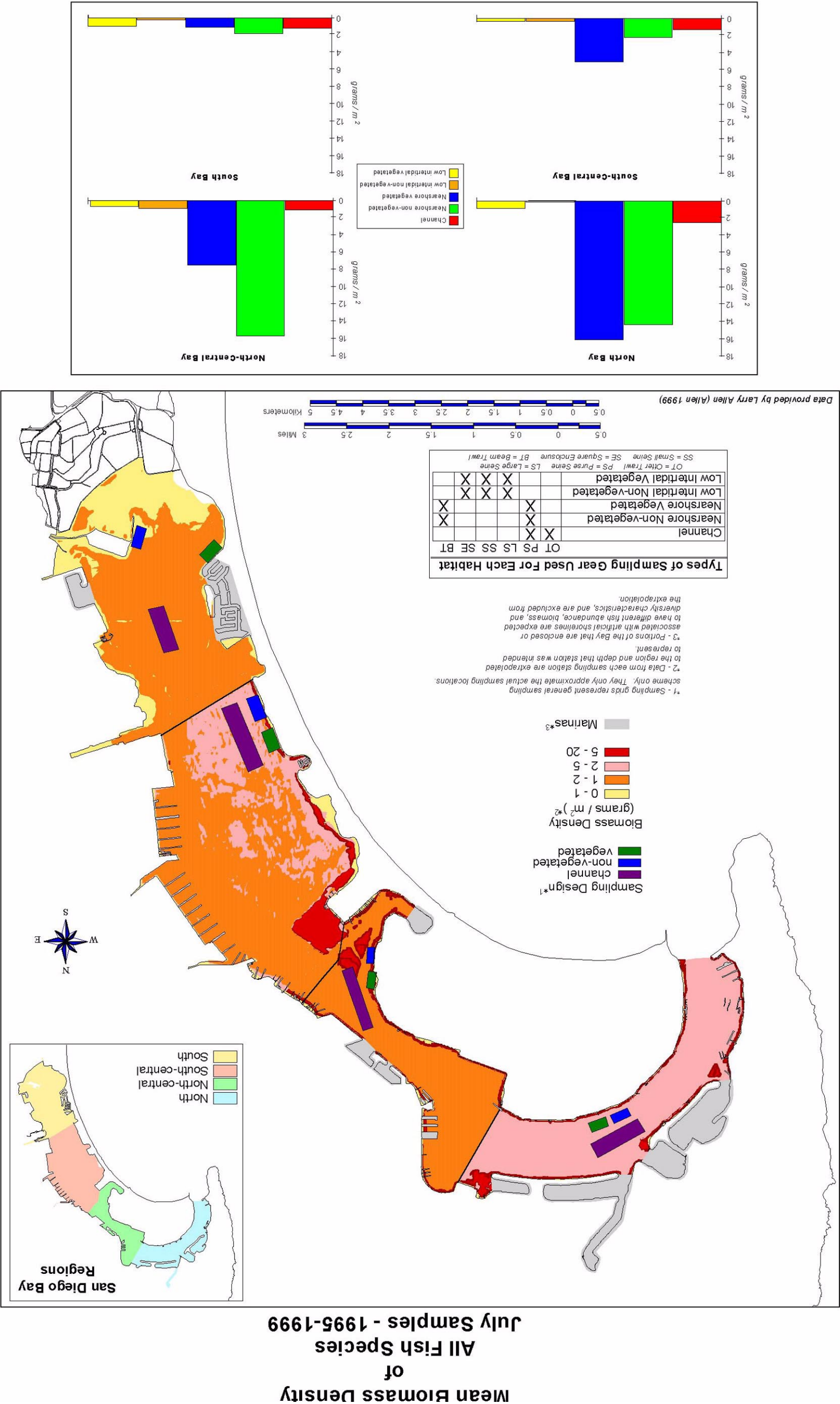

Map C-5. Mean Biomass Density of All Fish Species July Samples, 1994–1997.



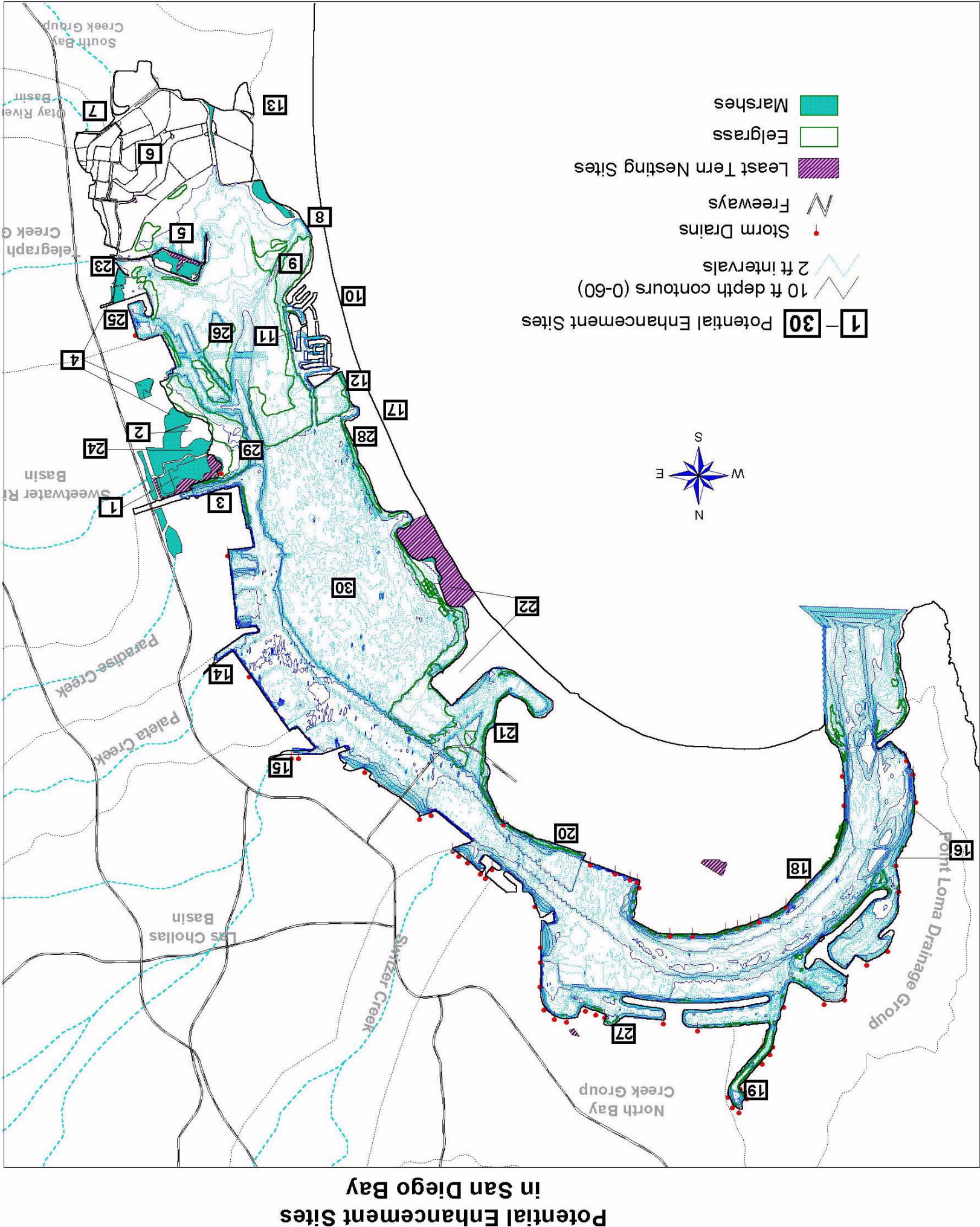

Possible Enhancement Sites (see text for details)		
1 - D street Fill (Mitigation Credit For Sale)	11 - Grand Caribe / Coronado Cays	22 - North Delta/NAB/ Least Tern Nesting shoreline
2 - Gunpowder Point	12 - Crown Cove and Navy land	23 - SDGE powerplant site
3 - National City Marina	13 - USN Radio Receiving Facility	24 - Sweetwater River mouth and flood control channel
4 - F, G, and J Street marshes, connector marsh, mudflats	14 - Paleta Creek mouth	25 - Port's Rohr site
5 - Chula Vista Wildlife Reserve	15 - Chollas Creek mouth	26 - Borrow area
6 - South Bay Salt Ponds	16 - Shoreline between USN SUBASE and fuel pier	27 - Convair Lagoon
7 - Lower Otay River Wetlands	17 - Silver Strand State Beach	28 - Alpha Beach/ Crown Cove
8 - Emory Reserve	18 - NAS North Island Shoreline	29 - Mudflat off of Sweetwater NWR
9 - Emory Cove Boat Basin and Channel	19 - NTC Boat Channel	30 - Moderately deep area that could be made shallower for enhancement
10 - Coastal Strand Dunes and Native Plant Restoration	20 - Coronado Bayfront	
	21 - Coronado golf course shoreline	

